

REVISIONS		
NO.	DESCRIPTION	DATE

**CONTRACTOR SHALL KEEP
11' MINIMUM LANES UNLESS
NOTED OTHERWISE.**

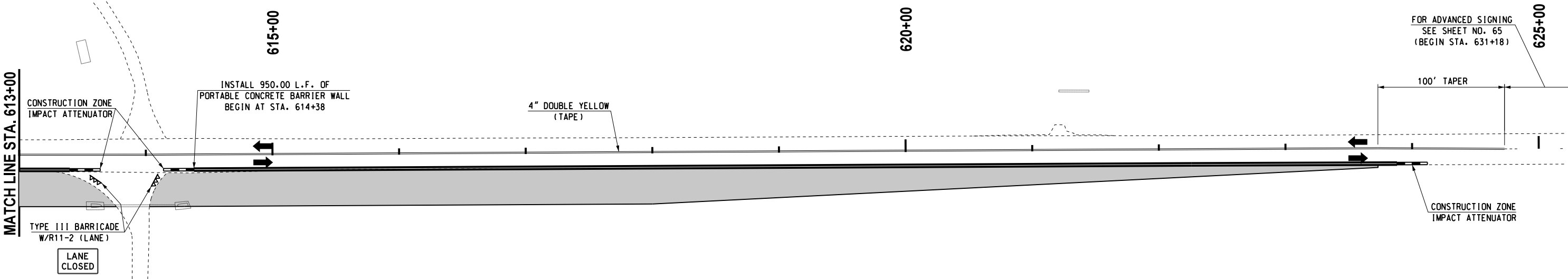
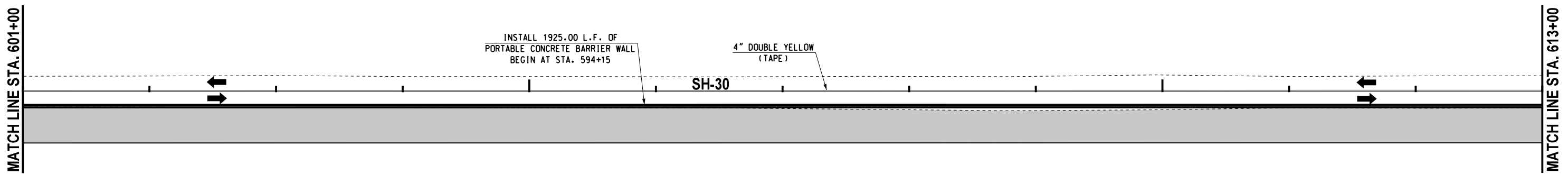
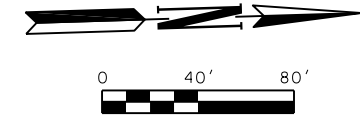

FOR ADVANCED SIGNING
SEE SHEET NO. 65
(BEGIN STA. 631+18)

100' TAPER

CONSTRUCTION ZONE
IMPACT ATTENUATOR

CONSTRUCTION ZONE
IMPACT ATTENUATOR

INSTALL 950.00 L.F. OF
PORTABLE CONCRETE BARRIER WALL
BEGIN AT STA. 614+38

4" DOUBLE YELLOW
(TAPE)

TYPE III BARRICADE
W/R11-2 (LANE)

LANE
CLOSED

SUGGESTED SEQUENCE OF CONSTRUCTION

- PHASE 2. SHIFT TRAFFIC WEST TO EDGE OF SH-30 (ONE LANE EACH DIRECTION)
- PLACE PORTABLE LONGITUDINAL BARRIER ALONG EAST EDGE OF EXISTING PAVEMENT
 - CONSTRUCT TEMP. CROSS DRAINS USING FLAGMEN
 - CONSTRUCT TEMP. ASPHALT WIDENING (C.L. SURV. SH-30 STA. 553+07 TO STA. 581+82 AND STA. 594+28 TO STA. 623+73)

LEGEND	
	- TYPE III BARRICADE W/ TWO TYPE "A" LIGHTS
	- DRUM
	- CHANNELIZER CONE
	- PORTABLE CONC. BARRIER WALL
	- CONSTRUCTION ZONE IMPACT ATTENUATOR
	- WORK AREA

Design	RWR	9/13/2016
Drawn	CCC	9/13/2016

TRAFFIC CONTROL PLANS
PHASE 2
(3 OF 3)

State Job No. 28768(04) Sheet No. 70

9/13/2016 G:\Projects\1-2356 SH 30 over Sat Fork of Red River\CAD\TC PHASE 2\AC - 3.dgn

S.H. 30 BRIDGE & APPROACHES HARMON COUNTY